

# FACTORY THEATRE

## TECHNICAL SPECIFICATIONS

### 01/09/23

## CONTENTS

Contacts

The Space

Lx Kit List

Sound Kit List

Extra equipment

Stage Management

## TOBACCO FACTORY THEATRES CONTACTS

**Tom Pitchers, Senior Technician:** [technical@tobaccofactorytheatres.com](mailto:technical@tobaccofactorytheatres.com)

**Operations Assistant:** 0117 902 0345 / [theatre@tobaccofactorytheatres.com](mailto:theatre@tobaccofactorytheatres.com)

# THE SPACE

The Factory Theatre is a non-conventional, versatile theatre space, which has been used for performance since 1998, exciting audiences and performers alike. Often described as 'intimate' and 'raw', the space seats between 205 and 300 people and can be arranged end-on, in the round or thrust. For touring seasons, the space is arranged end-on unless specified otherwise in the contract. Seating plans are available from Tom Pitchers (Senior Technician). The box office is located in the entrance to the building on the ground floor. The theatre is located on the first floor.

Height to ceiling 3.7m

Height to grid 3.5m

Width between pillars SR-SL 6.5m

Due to the nature of the building, there is the odd joist, pipe or air con duct below these heights, please call or email if you think this may be a problem.

## FLOOR

The theatre floor is a black painted wooden sheet floor, which can be screwed into with a maximum screw length of 30mm. The floor may need to be painted back to black as part of the VC get out. A black dance floor can be laid if arranged in advance with the Senior Technician (minimum notice of 6 weeks required and may incur costs to VC).

## Water

The original floor is very porous and even a spilled glass of water can end up seeping through the floor to the restaurant below the theatre. Please inform the Senior Technician at the time of booking if your production uses any water.

# Fire exits

A clear path for a potential audience evacuation needs to be maintained to the USR Fire Exit as well as the audience entrance at all times.

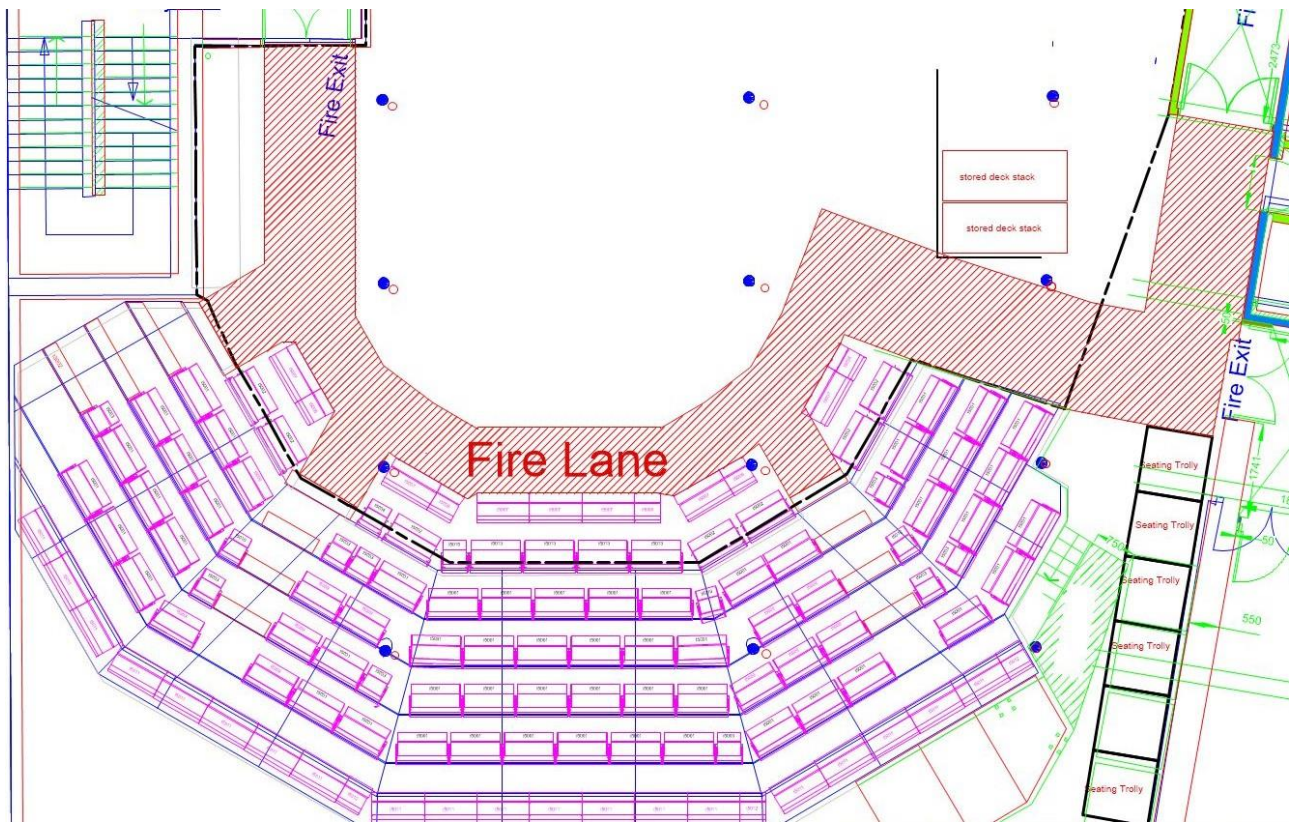

# The Building

The Tobacco Factory is a creative, mixed-use community building. The building has a collaborative buzz about it, with several businesses within the building working together. Tobacco Factory Theatres is a part of this larger building; which can create both opportunities and challenges.

## Markets-Sunday

Every Sunday Tobacco Factory is home to community market, with around 40 food and craft stalls in the building car park and extends the market into Raleigh Road. During these markets, loading in is only allowed before the market opens to the public at 09:00 or after 16:00 once the road is back open to the public.

## Parking

Onsite parking for Tobacco Factory Theatres is restricted to loading in only. Parking is available in the local area surrounding the theatre but please be aware of restrictions. If you would like further information or have concerns about parking, please contact the Senior Technician.

## GET IN

The Factory Theatre is based on the first floor of the Tobacco Factory. There is a small lift that will fit heavy but small objects. The lift dimensions are 1400mm x 1600mm x 2100mm

**Please note:**

The get-in involves 2 flights of stairs including a 180 degree turn and several double doorways with dimensions of 2100mm x 1550mm

## BACKSTAGE FACILITIES

The Factory Theatre has two air-conditioned dressing rooms with mirrors, wardrobes and rails. There is a toilet, an accessible toilet and shower next to the dressing rooms.

## Laundry

Tobacco Factory Theatres has a small laundry cupboard with 2 washing machines and 2 Tumble dryers. Please provide/bring your own washing consumables and note that all machines should be turned off and emptied overnight.

## Sound

The Tobacco Factory is a multi-use building and loud noise can disturb other building users above and below the theatre. If your production contains large amounts of sustained loud sound or anything that may disturb other building users, please inform the Senior Technician in advance of your arrival. (minimum of 6 weeks' notice required)

## NAKED FLAME

Any use of naked flame will require a full risk assessment and flame plot to be submitted to Tobacco Factory Theatres and approved by Tobacco Factory Theatres at least six weeks before the first performance.

## SMOKING IN THE WORKPLACE

Smoking is prohibited throughout the whole building, **including by actors onstage**. If smoking outside, please use the bins provided to dispose of cigarette butts. On stage we do allow prop e-cigarettes if they only give off a safe non-toxic vapour that, do not contain smoke, carcinogens, nicotine or smell. If you have any concerns, please email the Senior Technician.

## Access Cards

Tobacco Factory Theatres has a swipe card entry system. Programmed cards will be issued to you upon arrival and must be returned before departure. Please contact the Operations Assistant ([theatre@tobaccofactorytheatres.com](mailto:theatre@tobaccofactorytheatres.com)) with your company size, names and access requirements 3 weeks before your arrival to allow programming. There will be a £10 per card charge for the non-return or loss of these cards.

## LIGHTING

Lighting is rigged using 9 IWBs. The plan shows the positions of the lighting bars and IWBs. Data (DMX) is also supplied to points on each end of the IWBs. If required and

within reason, extra bars can be erected. 6 tank traps and some floor stands are available.

Venue intelligent units are addressed from 2/001-2/335. Whilst we are happy for you to readdress these, we would ask that you spend a moment to fit your addresses around these. Any changed addresses or modes will need to be reset before departure.

## Control

1 x ETC Ion

96 ways of ETC Sensor 3 dimming consisting of

72 ways of dimming

24 thru power / dimming /switching / hot power

## Lanterns

32 Selecon Acclaim Fresnel 650W

20 Strand Patt 743 Fresnel 1000W

18 ETC Source4 Junior Profile 25/50 Size M gobo 575W

15 ETC Source4 Par + lens set 750W

4 Parcan 64 (CP62) 1000W

4 Par 16 Birdies 50W

6 ETC Colour-Source Spot Deep Blue with either Fresnel adapters or Fixed lens Profile (Size B Gobo)

4 Robe Robin 300 LED wash moving heads - (Rigged in fixed position)

1 Unique 2.1 Haze machine DMX 2 channels - (charge for fluid)

Any and all electrical equipment brought by the company for both on stage or backstage/dressing room use must have evidence of Portable Appliance Testing or cannot be used within Tobacco Factory Theatres.

# SOUND

There is a show relay in place in the dressing rooms. The theatre has an IR assisted hearing system installed.

## Speakers

EM Acoustics

4 EMS-81x horizontally flown (Foh)

4 EMS-51 Flown (delays)

2 EMS-115 (subs)

6 JBL control 1 pro (Surrounds fixed positions)

4 JBL control 1 pro (Surrounds for when in the round fixed positions)

## Amps

3 QSC Rmx 1450 amplifiers

2 QSC Rmx 850 amplifiers

(Please note that the 850's cannot drive the EM81's or the subs)

1 cloud amp 6 way (surrounds)

1 cloud amp 4 way (surrounds when in the round)

## Desk

1 Behringer X32 Compact

1 S16 Stage box (+ one that feeds the amps fixed)

1 Mac Mini with Qlab 4 (pro Bundle license)

2 SM58LC microphones

1 SM57 microphones

# Extra equipment

Please contact the Senior Technician to ask about availability

The following are used across shared spaces, please contact 6 weeks for arrival

## Lighting

4 Robe LED Beam 150

3 Source4 fixed profiles

Lens for all Source4 fixed:

3x 19 degree

6x 26 degree

6x 36 degree

10x 50 degree

1x 70 degree

Lens for all Source4 Par:

12x VNSP

12x NSP

14x MFL

15x WFL

3 Sunstrip Active DMX (10Ch GU10)

1 Unique 2.1 haze machine DMX 2 channels - (charge for fluid)

1 Viper NT smoke machine - (charge for fluid)

8 ways of (3) Zero 88 Alpha packs

## sound

1 Yamaha Stagepas 400i speakers (1 powered with mixer 1 passive)

4 EMS-81 vertically flown (Foh)

4 EMS-51 Flown

1 QSC Rmx 1450 amplifier

1 QSC Rmx 850 amplifiers

1 Sd8 digital stage box

## AV

1 Vmix pc

1 Atem Mini-Pro



1 mevo start Camera  
2 cannon Cr N500 PTZ cams  
1 Birddog p100 PTZ Cam  
1 Z-cam E2-M4 cinema camera  
1 16/9 (2900mmx1600mm) fast fold screen (dual front-rear screen)

## STAGING

14 Metrodeck 1m x 2m  
legs to make 0.30m high decking  
legs to make 0.60m high decking  
legs to make 0.90m high decking  
legs to make 1.20m high decking  
(Please note staging is not stored on site so if required, transport costs may be incurred)

## Masking

Alongside a number of masking flats and drapes (for further/specific information please email the Senior Technician) There are 2 permanent full tab track positions.  
Mid Stage - Allowing for a depth from seating bank of 7.5m with a backstage space of 3.3m  
Up Stage - Allowing for a depth from seating bank of 9.7m with a backstage space of 1.1m

# STAGE MANAGEMENT

The Factory Theatre has a small control booth suitable for two people. This is only accessible via a rung ladder. The dressing rooms and backstage facilities are quick and easy to access. Access to the theatre Wi-Fi network is available in the theatre, theatre bar and dressing rooms. Please ask for the password on arrival.

## Calls

The theatre is equipped with a calls system to both dressing rooms and FOH

## Green go coms / que lights

|                    |   |
|--------------------|---|
| SM Desk GGO-MCXD   | 1 |
| Wall Panel Headset | 3 |
| Wall Panel Speaker | 1 |

We have a reasonable stock of masking flats and black drapes, but please email for any specific requirements.

## Technical Support

The standard technical support is one technician for in, out and duty tech for show calls who can operate lighting or sound. Please check Contract for any expected change to the above. If more staffing is required, this must be booked at least 8 weeks in advance through the Senior Technician. Any staff hours required outside of the contracted hours will be chargeable.