

SPIELMAN THEATRE

TECHNICAL SPECIFICATIONS

01/05/2022

CONTENTS

Contacts

The Space

The Building

Lighting Kit List

Sound Kit List

Extra Equipment

Stage Management

Technical Support

TOBACCO FACTORY THEATRES CONTACTS

Matthew Graham, Technical Manager: matt@tobaccofactorytheatres.com
Administration: 0117 902 0345 / theatre@tobaccofactorytheatres.com

"The future of theatre lies in places like this."
Jonathan Miller

—
Patron Mrs Mary Prior CVO MBE
Trustees Sarah Smith (Chair), Andrew Allan-Jones, Mike Forrest, Claudia McVie,
Bertel Martin, Mark Panay, Matt Penneyard, Anna Southall
Company no. 04536120 / Charity no. 1097542



Supported using public funding by
**ARTS COUNCIL
ENGLAND**

THE SPACE

The Spielman Theatre was built in 2018. It has an audience capacity of 84 arranged end-on with a retractable seating bank. The theatre is programmed all year round and is also home to our Get Involved programme who often use the space during the day with the seats retracted. The box office is located in the foyer of the building on the ground floor.

Stage width:

At its narrowest: 5470mm

At its widest: 6840mm

Room width above lobbies: 9.3m

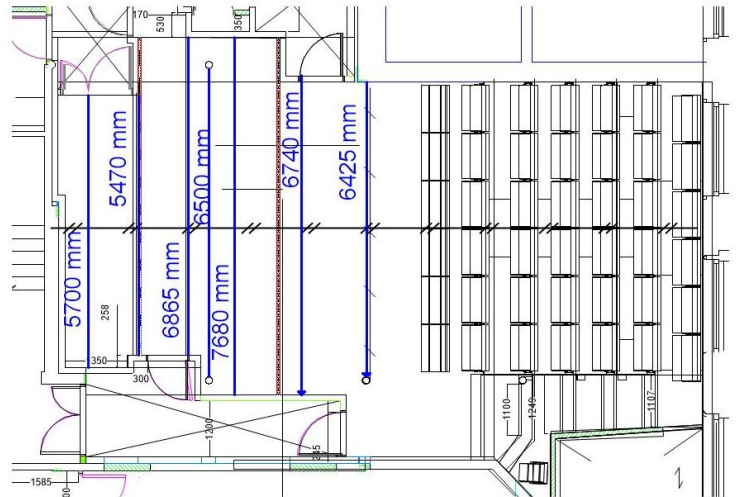

Stage depth:

When seating retracted: 10.4m

Stetting line to tab line: 4830mm

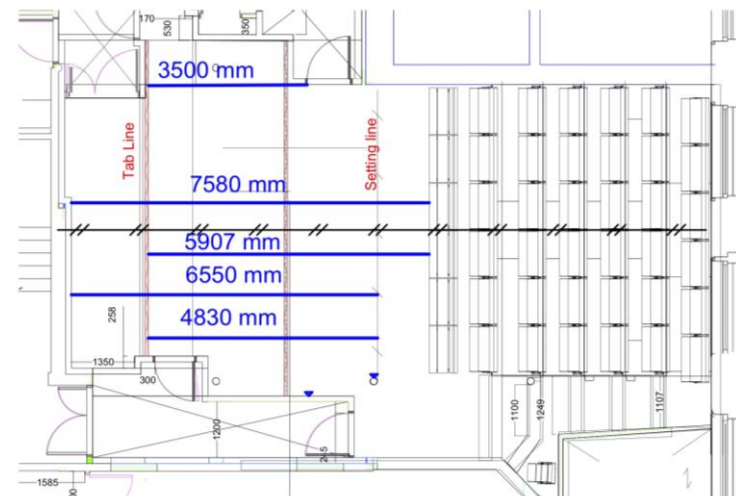

Height:

Height to Ceiling 3675mm

Height to IWB underside 3405mm

Height to RSJ 3400mm

Height to Aircon 3300mm

"The future of theatre lies in places like this."

Jonathan Miller

—
Patron Mrs Mary Prior CVO MBE

Trustees Sarah Smith (Chair), Andrew Allan-Jones, Mike Forrest, Claudia McVie, Bertel Martin, Mark Panay, Matt Penneyard, Anna Southall
Company no. 04536120 / Charity no. 1097542



Supported using public funding by
ARTS COUNCIL ENGLAND

It is possible to access the stage from both SL and SR.
Upstage right is only accessible through public spaces.

SEATING BANK

The Spielman Theatre has a tiered retractable bank with a low banquette front row. The audience access aisle runs up one side of the seating bank - to the audience's left. There is no access to the seating from the right-hand side (seating abuts the wall).

CHAIR STORAGE

Unless arranged otherwise the space between the back tab track and the back wall will be used to store chair trolleys and will not be useable space. LX 9 is the last useable LX bar in front of the tab.

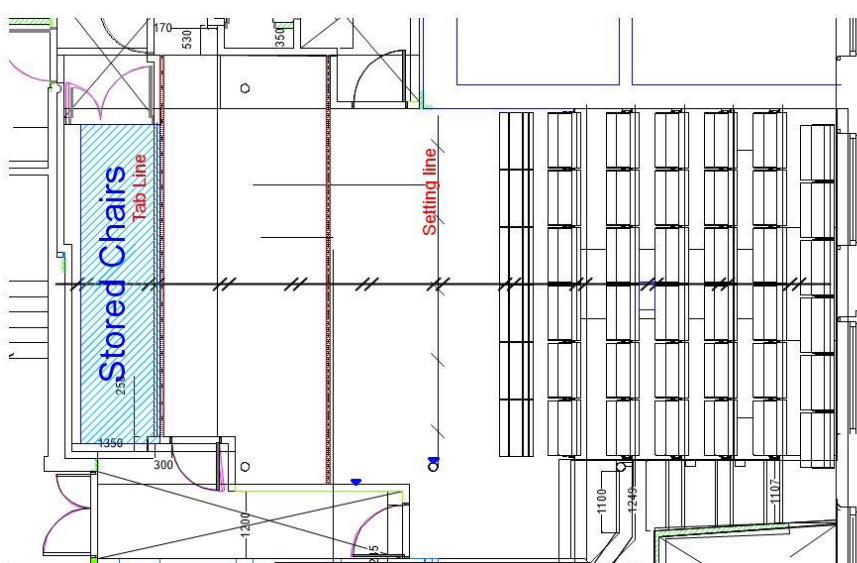

FLOOR

Black painted hardboard

MIXED USE

The Spielman Theatre is a mixed-use space and is also used for workshops, youth theatre, community classes and hires. This means there is a possibility we will ask you to strike set and props as well as clear down the dressing room between shows.

"The future of theatre lies in places like this."
Jonathan Miller

—
Patron Mrs Mary Prior CVO MBE
Trustees Sarah Smith (Chair), Andrew Allan-Jones, Mike Forrest, Claudia McVie, Bertel Martin, Mark Panay, Matt Penneyard, Anna Southall
Company no. 04536120 / Charity no. 1097542



Supported using public funding by
ARTS COUNCIL ENGLAND

FIRE EXITS

There are two fire exits from the auditorium, one on each side of the stage. These need to be kept clear at all times.

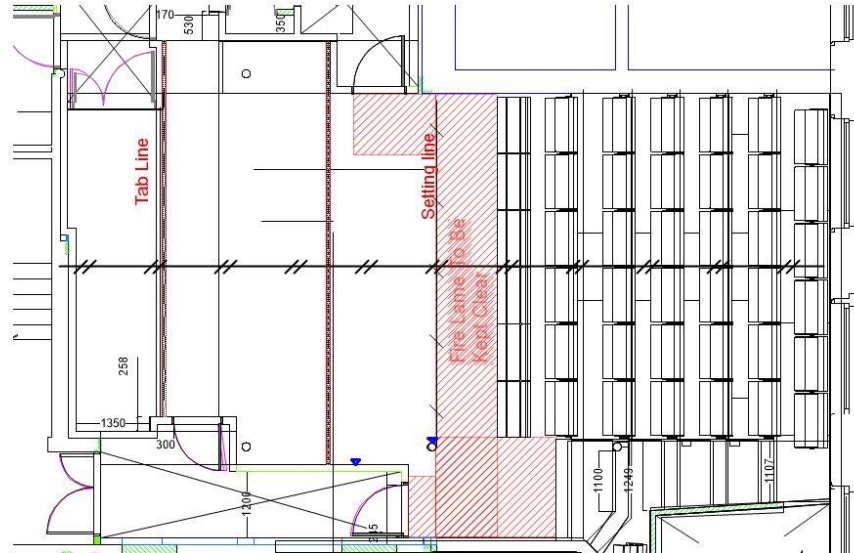

"The future of theatre lies in places like this."
Jonathan Miller

—
Patron Mrs Mary Prior CVO MBE
Trustees Sarah Smith (Chair), Andrew Allan-Jones, Mike Forrest, Claudia McVie,
Bertel Martin, Mark Panay, Matt Penneyard, Anna Southall
Company no. 04536120 / Charity no. 1097542



Supported using public funding by
**ARTS COUNCIL
ENGLAND**

THE BUILDING

The Tobacco Factory is a creative, mixed-use community building. The building has a creative and collaborative buzz about it, with several businesses within the building working together. Tobacco Factory Theatres is a part of this larger building; which can create both opportunities and also challenges.

MARKETS

Every Sunday Tobacco Factory is home to community market, with around 40 food and craft stalls in the building car park and extends the market into Raleigh Road. During these markets, loading in is only allowed before the market opens to the public at 09:00

PARKING

Onsite parking for Tobacco Factory Theatres is restricted to loading in only. Parking is available in the local area surrounding the theatre but please be aware of restrictions. If you would like further information or have concerns about parking please contact the Technical Manager.

GET IN

The Spielman Theatre is based on the first floor of the Tobacco Factory. There is a small lift that will fit heavy but small objects. The lift dimensions are 1400mm x 1600mm x 2100mm

Please note: The get-in involves 2 flights of stairs including a 180° turn and several double doorways with dimensions of 2100mm x 1550mm

BACKSTAGE FACILITIES

The Spielman Theatre has one air-conditioned dressing room with a shower, toilet, seating for four, lockable wardrobe and storage space. It is situated back stage with doored access to upstage left and a public corridor.

"The future of theatre lies in places like this."
Jonathan Miller

—
Patron Mrs Mary Prior CVO MBE
Trustees Sarah Smith (Chair), Andrew Allan-Jones, Mike Forrest, Claudia McVie, Bertel Martin, Mark Panay, Matt Penneyard, Anna Southall
Company no. 04536120 / Charity no. 1097542



Supported using public funding by
**ARTS COUNCIL
ENGLAND**

LAUNDRY

Tobacco Factory Theatres has a small laundry cupboard with 2 washing machines and 2 tumble dryers. These are accessed from a public corridor. Should you require access to the washing facilities during your visit please contact the theatre administrator in advance of your arrival.

SOUND

The Tobacco Factory is a multi-use building and loud noise can disturb other building users above and below the theatre. If your production contains large amounts of sustained loud sound or anything that may disturb other building users, please inform the Technical Manager in advance of your arrival.

NAKED FLAME

Any use of naked flame will require a full risk assessment and flame plot to be submitted to Tobacco Factory Theatres and approved by Tobacco Factory Theatres at least six weeks before the first performance.

SMOKING IN THE WORKPLACE

Smoking is prohibited throughout the whole building, including by actors onstage. If smoking outside, please use the bins provided to dispose of cigarette butts. On stage we do allow prop e-cigarette as long as they only give off a safe non-toxic vapour that, does not contain smoke, carcinogens, nicotine or smell.

ACCESS CARDS

Tobacco Factory Theatres has a swipe card entry system. Two programmed cards will be issued to you upon arrival and must be returned before departure. There will be a charge for loss of these cards.

"The future of theatre lies in places like this."
Jonathan Miller

—
Patron Mrs Mary Prior CVO MBE
Trustees Sarah Smith (Chair), Andrew Allan-Jones, Mike Forrest, Claudia McVie, Bertel Martin, Mark Panay, Matt Penneyard, Anna Southall
Company no. 04536120 / Charity no. 1097542



Supported using public funding by
**ARTS COUNCIL
ENGLAND**

LIGHTING

Lighting is rigged using 10 IWB's with 8 ways each. Data (DMX) is also supplied to three points on each bar. At stage level there are 4 production lighting panels each with 4 ways of dimming, hot power and data.

House lights/working lights are a permanently installed GDS System that is dmx controllable.

The plan shows the positions of the lighting bars and IWB's. If required and within reason, extra bars can be erected.

2 tank traps and some floor stands are available.

CONTROL

1 ETC Nomad PC (1024 channel licensee) With X keys and touchscreen monitor

48 ways of ETC Sensor 3 dimming consisting of

24 thru power modules / dimming / switching / hot power

1 Response 4-Port Gateway

3 Swisson DMX buffers

LANTERNS

12 Selecon Acclaim Fresnel 650W

4 Selecon Rama Fresnel 1000W

6 ETC Source 4 Junior Profile 25/50 Size M gobo 575W

6 Parcan 64 (CP62) 1000W

2 Robe LED Beam 150

4 ETC ColorSource Spot Deep Blue

- with either Fresnel adapters or Fixed lens Profile

- ColorSource Spots are B size gobo

Any and all electrical equipment brought by the company for both on stage or backstage/dressing room use must have evidence of Portable Appliance Testing or cannot be used within Tobacco Factory Theatres.

"The future of theatre lies in places like this."

Jonathan Miller

—
Patron Mrs Mary Prior CVO MBE
Trustees Sarah Smith (Chair), Andrew Allan-Jones, Mike Forrest, Claudia McVie, Bertel Martin, Mark Panay, Matt Penneyard, Anna Southall
Company no. 04536120 / Charity no. 1097542



Supported using public funding by
**ARTS COUNCIL
ENGLAND**

SOUND

There is a show relay in place in the dressing room.

SPEAKERS

EM Acoustics

2 EMS-81x horizontally flown (FOH)

1 EMS-61 Flown (centre)

1 EMS-115 (subs)

2 EMS-51 (surrounds)

2 EMS-51 (upstage)

AMPS

2 QSC rmx1450a 1 for 2 EMS-81x; 1 for 1 EMS-61's Flown centre and 1 EMS-115 subs

2 QSC rmx850a 1 for 2 EMS-51 Surrounds; 1 for 2 EMS-51's Up stage

CONTROL

1 Behringer X32 Compact with 32 channel usb interface

1 Behringer S16 digital stagebox (+ one SD8 that feeds the amps, fixed)

1 Mac Mini with QLab 4 (pro audio licence)

MICROPHONES

3 SM58LC microphones

DATA PATCH

Cat 6 Facility panels are located throughout the studio and terminate in a patch panel at the control position.

Please note there is no analogue mic XLR patch

"The future of theatre lies in places like this."

Jonathan Miller

—

Patron Mrs Mary Prior CVO MBE

Trustees Sarah Smith (Chair), Andrew Allan-Jones, Mike Forrest, Claudia McVie, Bertel Martin, Mark Panay, Matt Penneycard, Anna Southall

Company no. 04536120 / Charity no. 1097542



Supported using public funding by
**ARTS COUNCIL
ENGLAND**

EXTRA EQUIPMENT

PLEASE CONTACT THE TECHNICAL MANAGER TO ASK ABOUT AVAILABILITY

LIGHTING

4 Robe LED Beam 150

6 ETC ColorSource Spot Deep Blue with either fresnel adapters or fixed lens profile

ColorSource Spots are –B size gobo

3 Source 4 fixed profiles 750W

Lens for Source 4 fixed

3x 19 degree

6x 26 degree

6x 36 degree

10x 50 degree

1x 70 degree

3 Sunstrip Active DMX

1 Unique 2.1 haze machine DMX 2 channels (charge for fluid)

1 Viper NT smoke machine (charge for fluid)

SOUND

1 Yamaha Stagepas 400i speakers (1 powered with mixer 1 passive)

4 EMS-81 vertically flown

4 EMS-51 horizontally flown

1 QSC Rmx 1450 amplifier

1 QSC Rmx 850 amplifiers

1 Sd8 digital stage box

COMMS

1 Stonewood PSU 2 rings

4 Beltpack / headset

"The future of theatre lies in places like this."

Jonathan Miller

—
Patron Mrs Mary Prior CVO MBE

Trustees Sarah Smith (Chair), Andrew Allan-Jones, Mike Forrest, Claudia McVie,
Bertel Martin, Mark Panay, Matt Penneyard, Anna Southall
Company no. 04536120 / Charity no. 1097542



Supported using public funding by
**ARTS COUNCIL
ENGLAND**

AV

1 Vmix pc
1 Atem mini Pro
1 Mevo start Camera
2 Cannon Cr N500 PTZ cams
1 Birddog p100 PTZ Cam
1 Z-cam E2-M4 cinema camera
1 ViewSonic Pro8400 projector
1 16/9 (2900mmx1600mm) fast fold screen (dual front-rear screen)

STAGING

14 Metrodeck 1m x 2m
legs to make 0.30m high decking
legs to make 0.60m high decking
legs to make 0.90m high decking
legs to make 1.20m high decking

(Please note staging is not stored on site so if required, transport costs may be incurred)

"The future of theatre lies in places like this."
Jonathan Miller

—
Patron Mrs Mary Prior CVO MBE
Trustees Sarah Smith (Chair), Andrew Allan-Jones, Mike Forrest, Claudia McVie,
Bertel Martin, Mark Panay, Matt Penneyard, Anna Southall
Company no. 04536120 / Charity no. 1097542



Supported using public funding by
**ARTS COUNCIL
ENGLAND**

STAGE MANAGEMENT

The Spielman Theatre has a control position situated to the audience left of the seating bank suitable for two people. (One person can operate both lighting and sound)
The control position is accessed from the seating bank steps without having to pass through audience.

The dressing rooms and backstage facilities are quick and easy to access. Access to the theatre Wi-Fi network is available in the theatre bar and dressing rooms. Please ask for the password on arrival.

CALLS

The Studio Theatre is equipped with a calls system to both dressing rooms and FOH

COMMS AND CUE LIGHTS

The Studio Theatre has a Green-Go Digital intercom system consisting of the following:

Beltpack X	2
Single Muff Head sets	2

TECHNICAL SUPPORT

The standard technical support is one technician for in, out and duty tech for show calls who can operate lighting or sound. Please check Contract for any expected change to the above. If more staffing is required this must be booked at least 8 weeks in advance through the Technical Manager. Any staff hours required outside of the contracted hours will be chargeable.

"The future of theatre lies in places like this."
Jonathan Miller

—
Patron Mrs Mary Prior CVO MBE
Trustees Sarah Smith (Chair), Andrew Allan-Jones, Mike Forrest, Claudia McVie, Bertel Martin, Mark Panay, Matt Penneyard, Anna Southall
Company no. 04536120 / Charity no. 1097542



Supported using public funding by
**ARTS COUNCIL
ENGLAND**